

D-Day 75: Transforming the D-Day Museum

Presentation to CLS CM Meeting, 11 December 2015





- Maximise Exhibition Spaces
- Provide Learning/Conference/Community Space
- Create an open and inviting entrance
- Provide cafe spaces accessible to all
- Improve visitor flow and orientation
- Consolidate plant & improve exhibition environments
- Provide appropriate back of house facilities



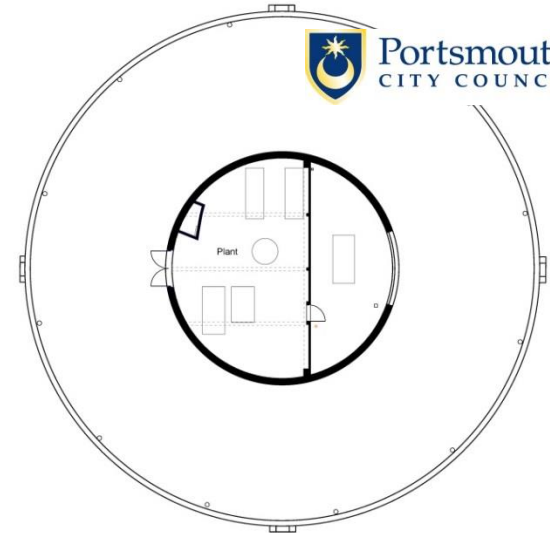
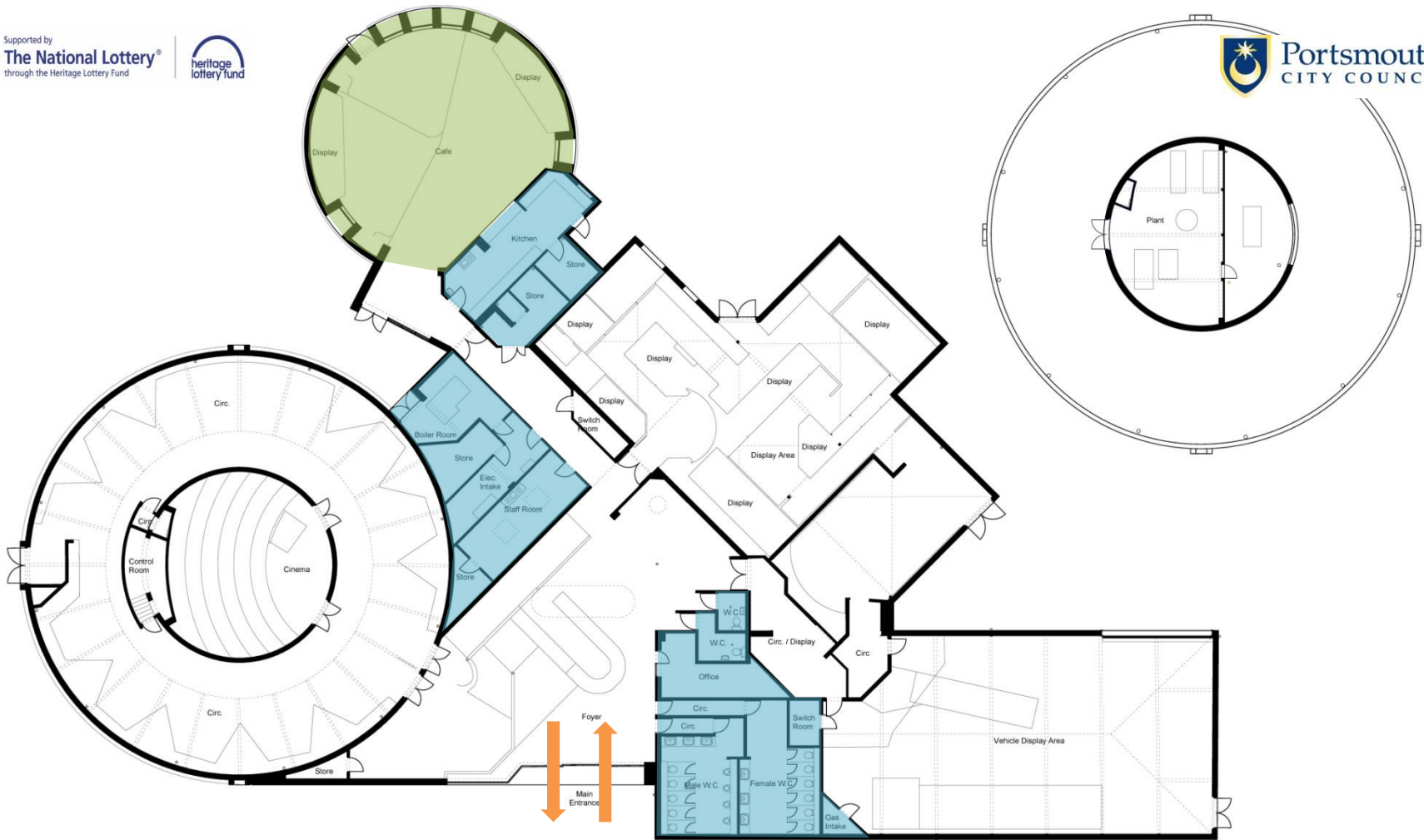

0 3 5 8 10 13 M

Notes
1 This drawing is © copyright Hampshire County Council 2015. No unauthorised reproduction of any kind is permitted.
2 No Dimensions to be scaled from this drawing.
3 This map is reproduced from Ordnance Survey material with the permission of Ordnance Survey on behalf of the controller of Her Majesty's Stationery Office © Crown copyright. Unauthorised reproduction infringes Crown Copyright and may lead to prosecution or civil proceedings (100019180) (2015)

rev	description	date	by

<p>Hampshire County Council</p>		<p>HCC Property Services, Three Storey House, 75 High Street, Winchester SO23 8JA, Tel: 01962 547761</p>	
<p>PROJECT D-Day Museum Portsmouth</p>		<p>SHEET CONTENTS Existing Floor Plan</p>	
<p>SCALE 1:100@A1 1:200@A3</p>	<p>DATE 18/09/15</p>	<p>DRAWN LT</p>	<p>CHKD GP</p>
<p>DRAWING NO. E02889 - 202</p>		<p>FILE REF. E02889 Existing Floor Plans</p>	
<p>REVISION</p>		<p>REVISION</p>	

Stage D report

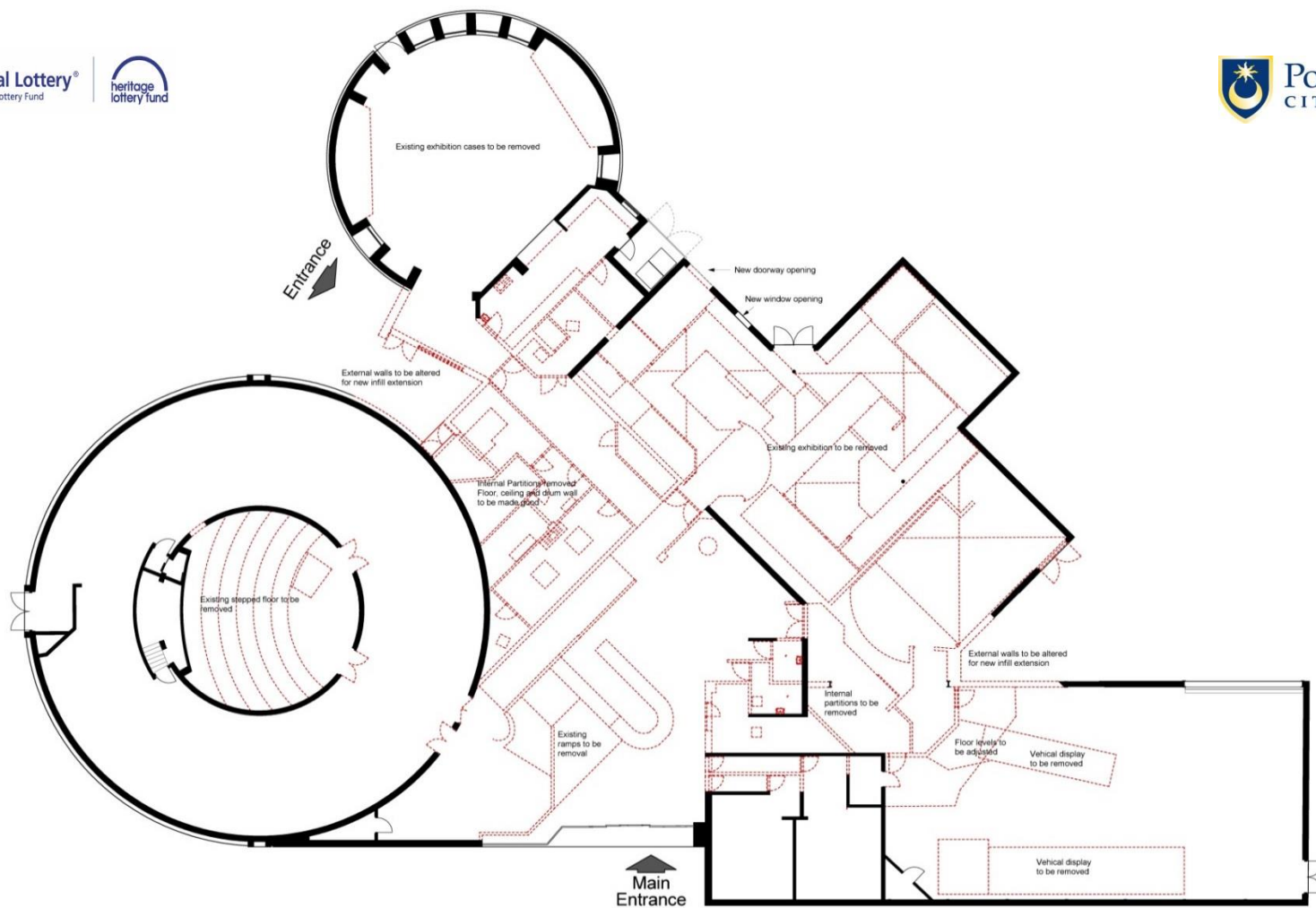

Key
— Walls Existing
--- Walls Demolished

0 5 10 M



Notes

- 1 This drawing is © copyright Hampshire County Council 2015. No unauthorised reproduction of any kind is permitted.
- 2 All dimensions to be scaled from this drawing.
- 3 This map is reproduced from Ordnance Survey material with the permission of Ordnance Survey on behalf of the Controller of Her Majesty's Stationary Office © Crown copyright. Unauthorised reproduction infringes Crown Copyright and may lead to prosecution or civil proceedings. (100019185) (2015)

Rev	Description	Date	By

Hampshire County Council		Stage D Report	
PROJECT D-Day Museum Portsmouth		SHEET CONTENTS Proposed Ground Floor Plan Fabric Removal Plan	
SCALE 1:100@A1 1:200@A3	DATE 18/08/15	DRAWN LT	CHECKED GP
DRAWING NO E02889 - 213		REVISION	
FILE REF E02889 211 - 220 Proposed Plans		HCC Property Services, Three Minerva House, 76 High Street, Winchester SO23 8JA, tel: 01962 347921	

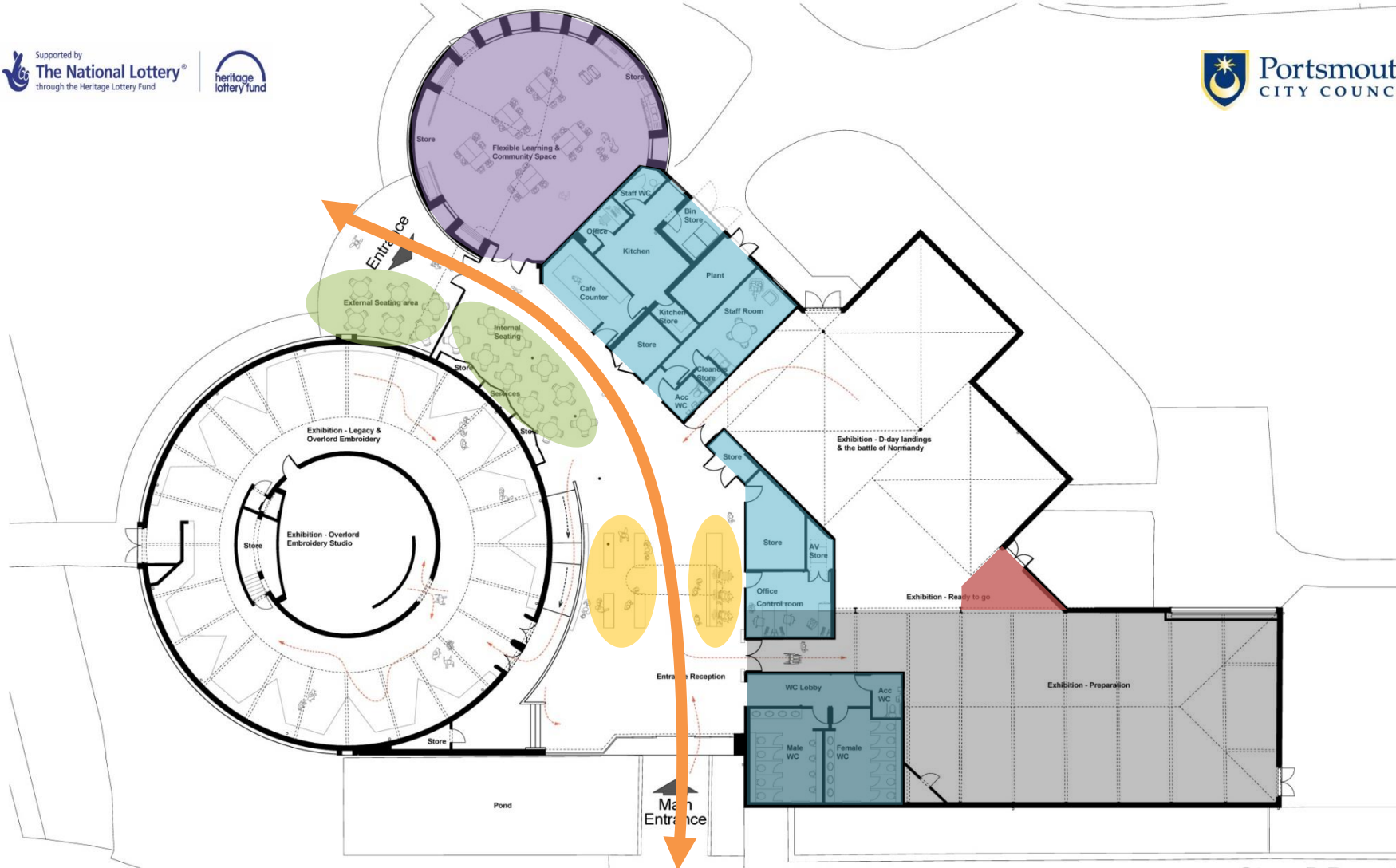

Stage D Report

0 5 10 M



Notes

- 1 This drawing is © copyright Hampshire County Council 2015. No unauthorised reproduction of any kind is permitted.
- 2 No dimensions to be scaled from this drawing
- 3 This map is reproduced from Ordnance Survey material with the permission of Ordnance Survey on behalf of the Controller of Her Majesty's Stationery Office © Crown Copyright. Unauthorised reproduction infringes Crown Copyright and may lead to prosecution or civil proceedings. (100019185), (2015)

Rev	Description	Date	By

Hampshire County Council		HCC Property Services, Three Minsters House, 76 High Street, Winchester SO23 8JL, Tel: 01962 347363	
PROJECT D-Day Museum Portsmouth		SHEET CONTENTS Proposed Ground Floor Plan	
SCALE 1:100@A1 1:200@A3	DATE 18/08/15	DRAWN LT	CHKD GP
DRAWING NO. E02889 - 211		REVISION E02889 211 - 220 Proposed Plans	

Transforming the D-Day Museum

GA Plan North-East Isometric View

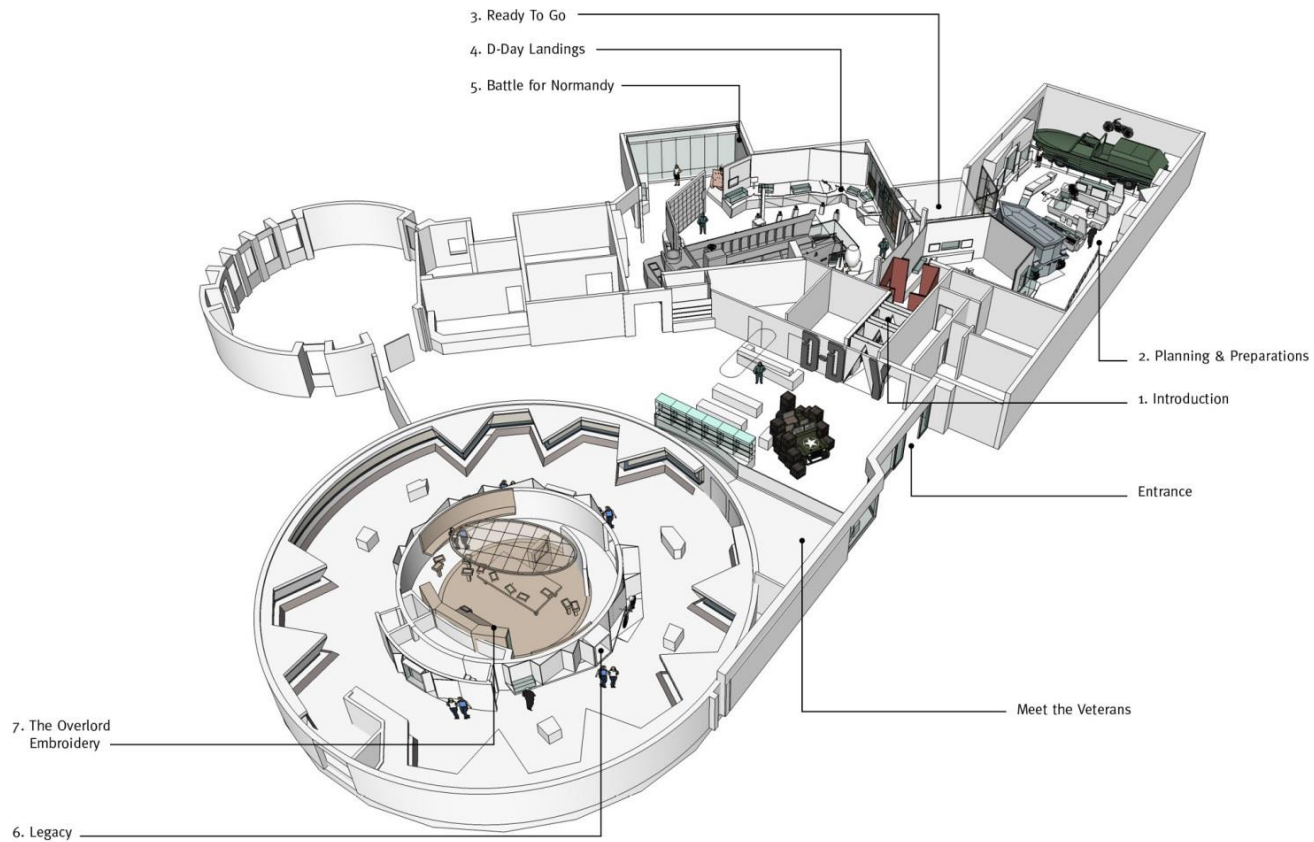

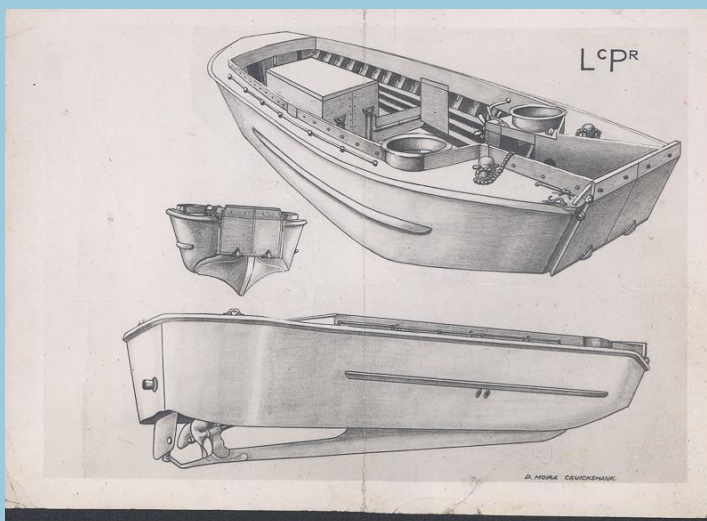
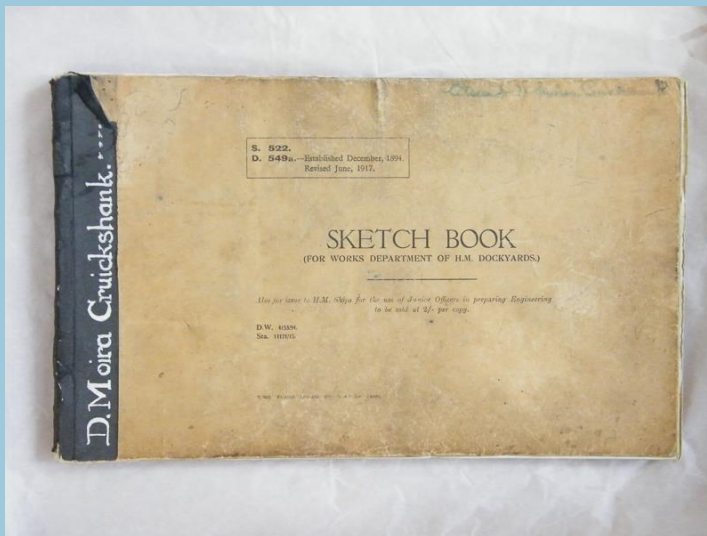

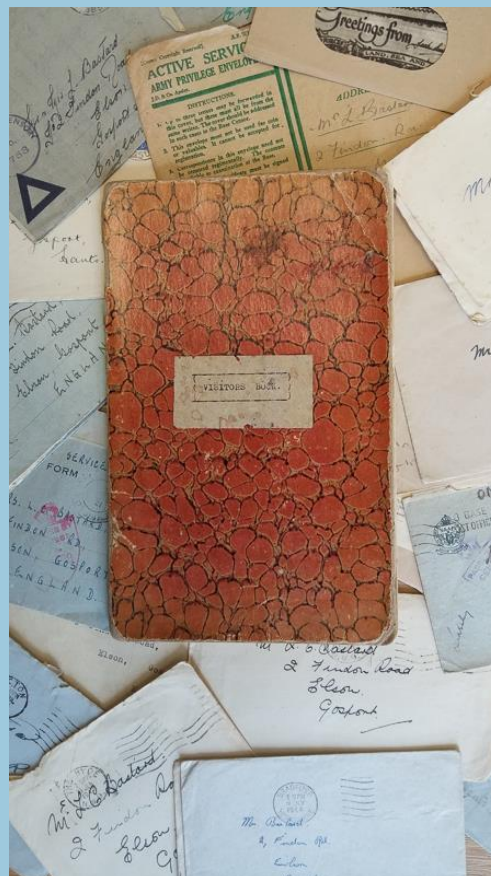

Gallery 2. Planning and Preparations

Concept Sketch Visual

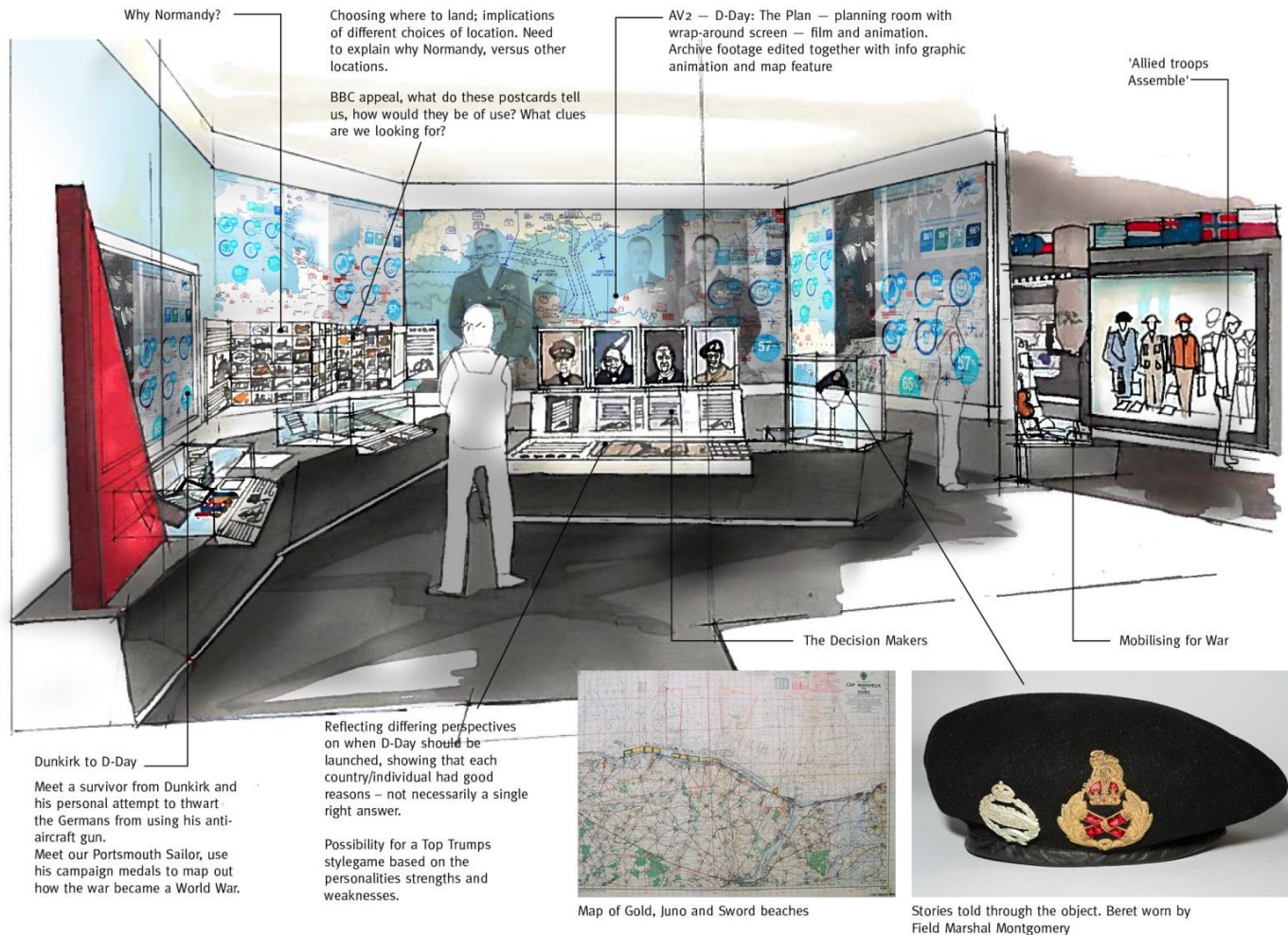

Gallery 2. Planning and Preparations

Concept Sketch Visual

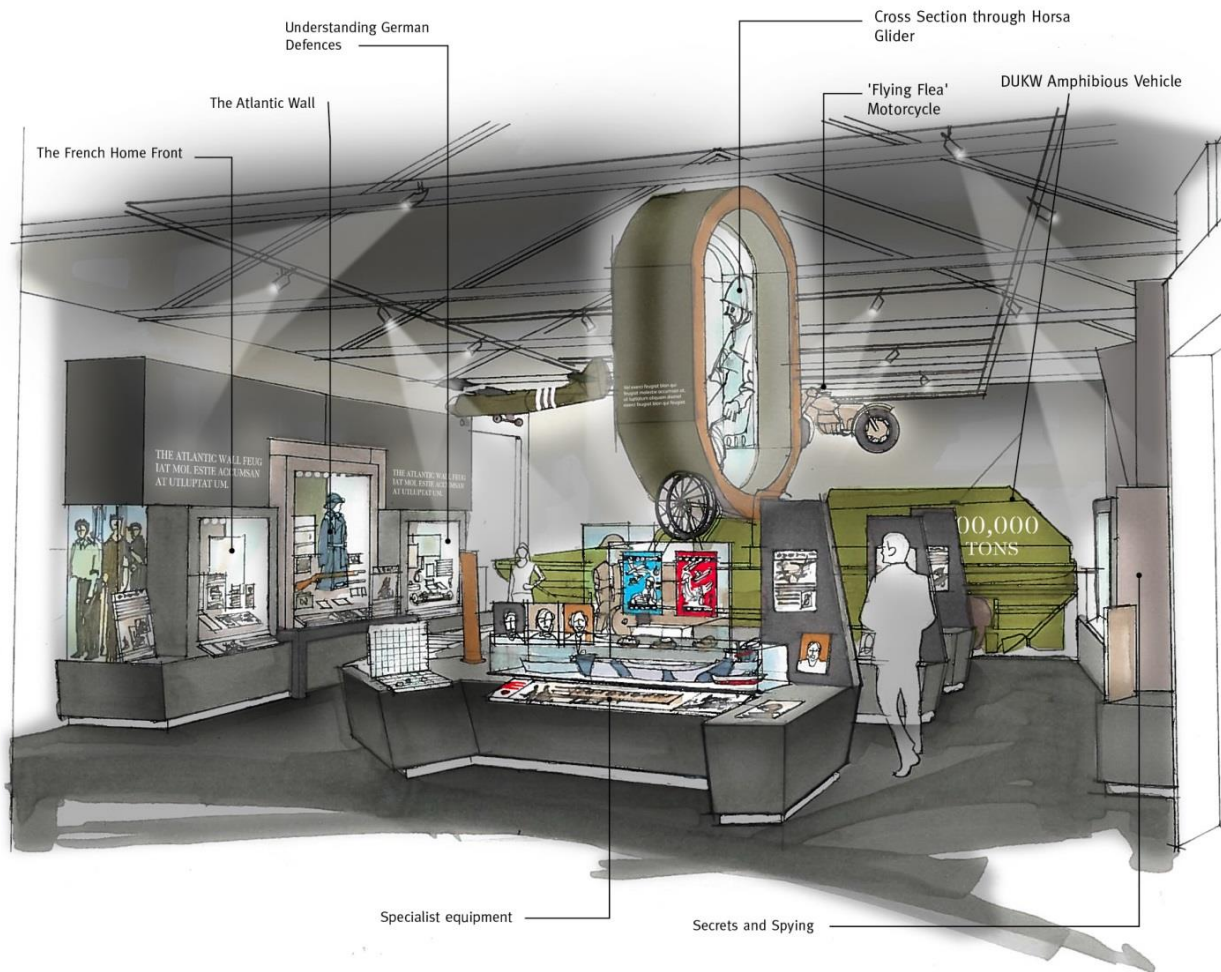

Cross-sectional graphics



Dynamic display architecture



Gallery 3. Ready to Go

Concept Sketch Visual

Letters of encouragement from Allied Commanders are presented in front of AV:

- Montgomery
- Eisenhower
- Ramsay

Or weather maps 10 days preceding sea crossing.

Bypass route clearly marked with lighting.

BARV
 Modified Sherman Tank



Roman Army Museum
 — full size digital Recruiting Officer

Full height digital AV monitor where various characters come forth and recount their thoughts and fears before the Channel crossings commence.

'Loose' seating for flexible arrangement to suit varying visitor groups.

Visitors pass through wire fencing into locked down marshalling area in the final hours before crossing.

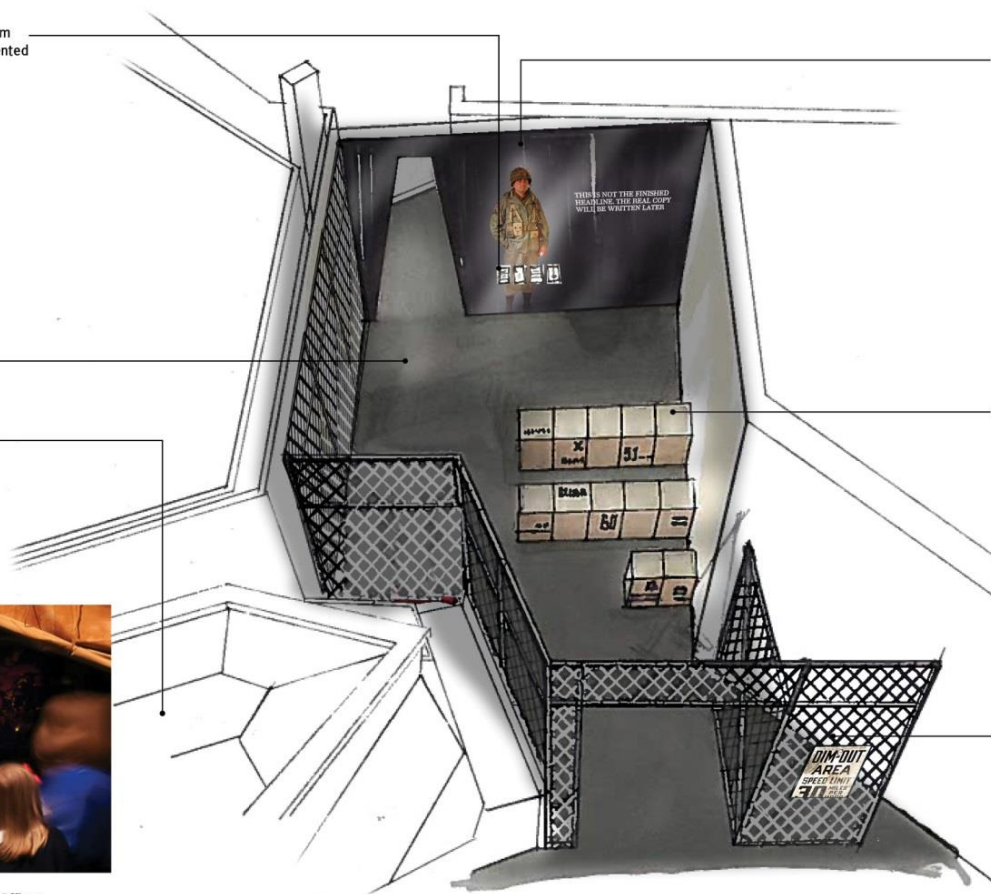

Gallery 4. D-Day Landings

Concept Sketch Visual

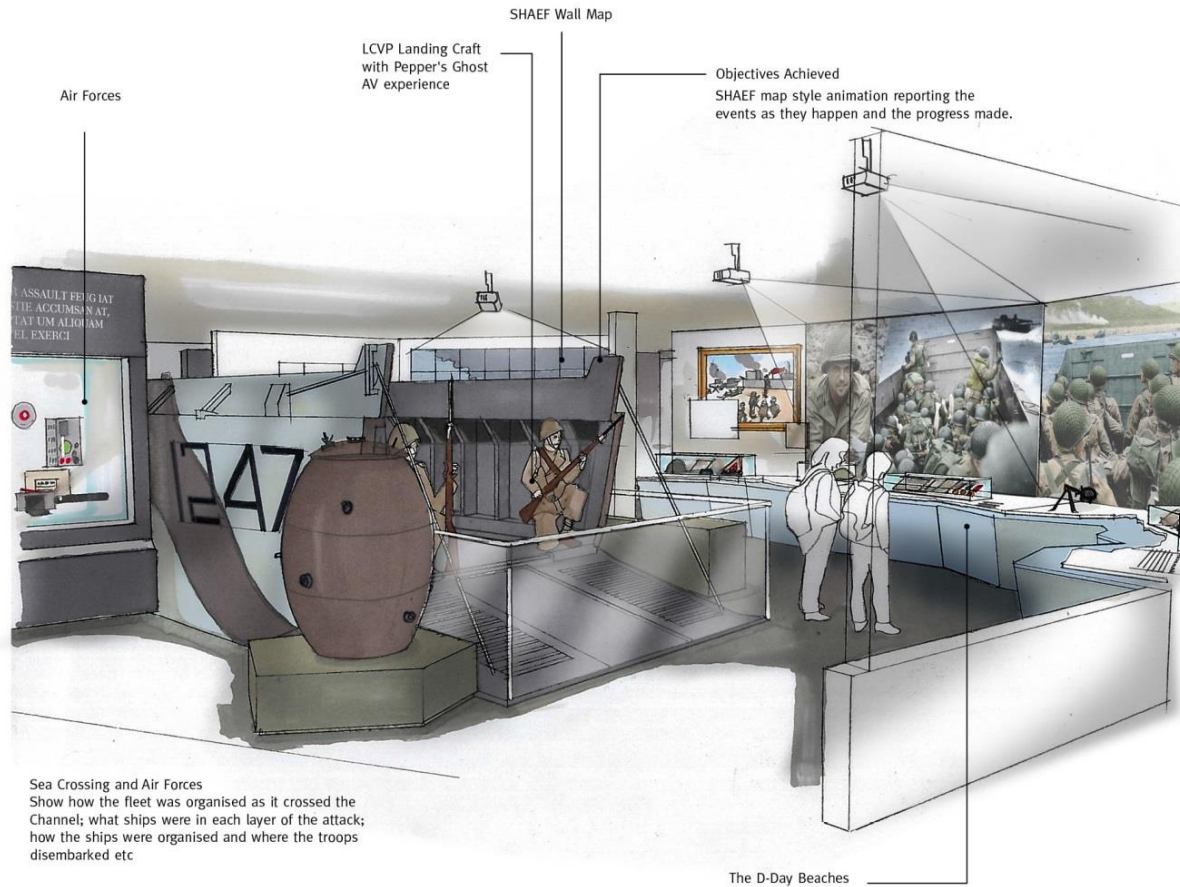

Models to create better understanding of numbers



Normandy coast line



Gallery 4. D-Day Landings

AV 6 — Concept Sketch Visual

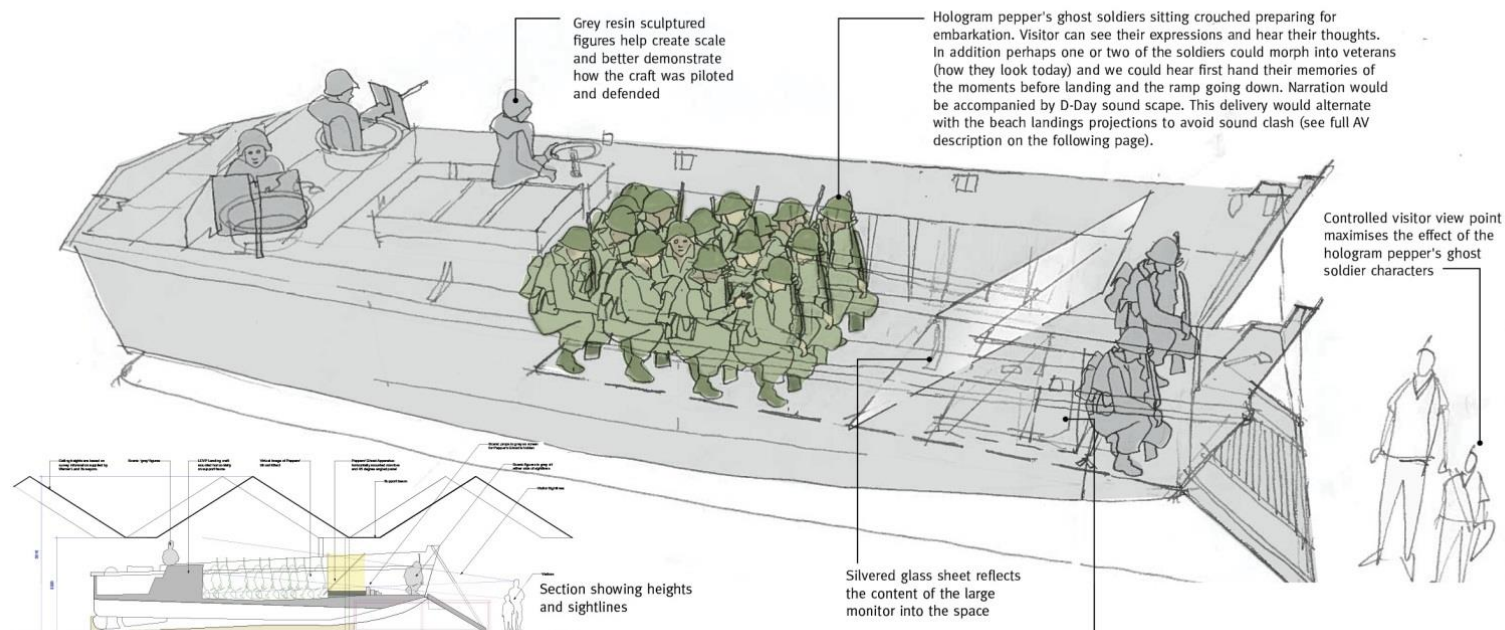

Resin sculptured figures can show facial expression, clothing and equipment



Hologram pepper's ghost soldiers sitting crouched preparing for embarkation. Visitor can see their expressions and hear their thoughts.

Large monitor set on its back and hidden from visitor view is reflected in the silvered glass sheet projecting the pepper's ghost image within the space

Gallery 6. Legacy

Embroidery Display Concept Sketch Visual

Below the embroidery showcase it is proposed to incorporate a continuous Interpretative ribbon as a means of make the narrative more accessible. This ribbon will also act as a barrier below the extending points of the glazing to prevent visitors walking into the cases



A panel from an earlier sequence of the Overlord Embroidery

Drop down captions offer an opportunity for personal commentary from Sandra Lawrence

Gallery 7. The Making of the Overlord Embroidery

Concept Sketch Visual

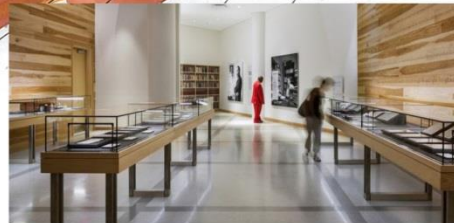
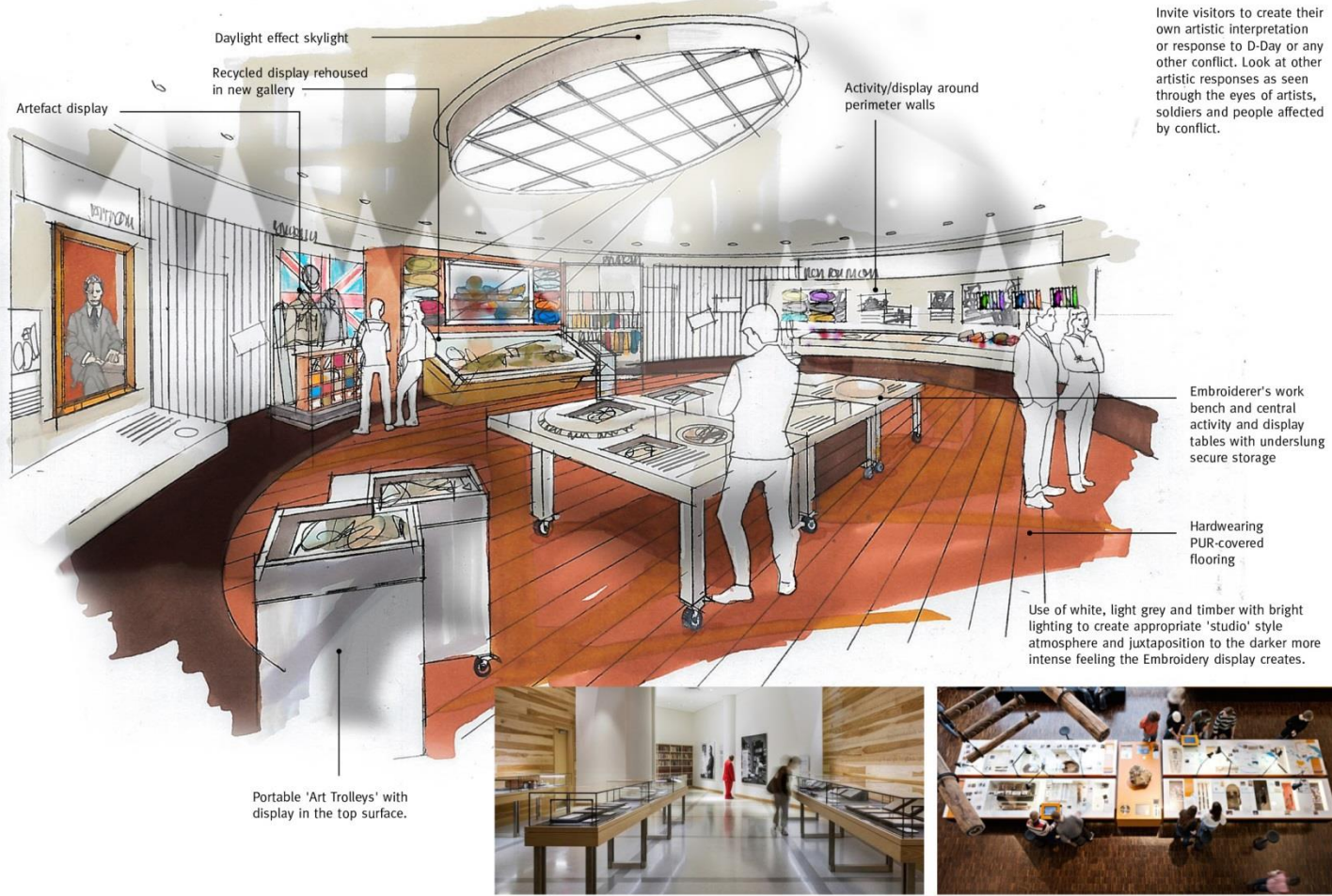

Any Questions?